

# TECHNICAL DATASHEET



## REDUCED TEE 90°

03 Update - 04/2024

### TECHNICAL DATA

Article No	001 115 0042 0232
d1 (mm)	225
d2 (mm)	90
L (mm)	527
le1 (mm)	125
le2 (mm)	83
Z (mm)	222
s1 (mm)	13,4
s2 (mm)	5,4
Weight (Kg)	6,380
Box Quantity (pcs)	2
Box Dimension (pcs)	48x56x38,5

### INJECTION MOULDED

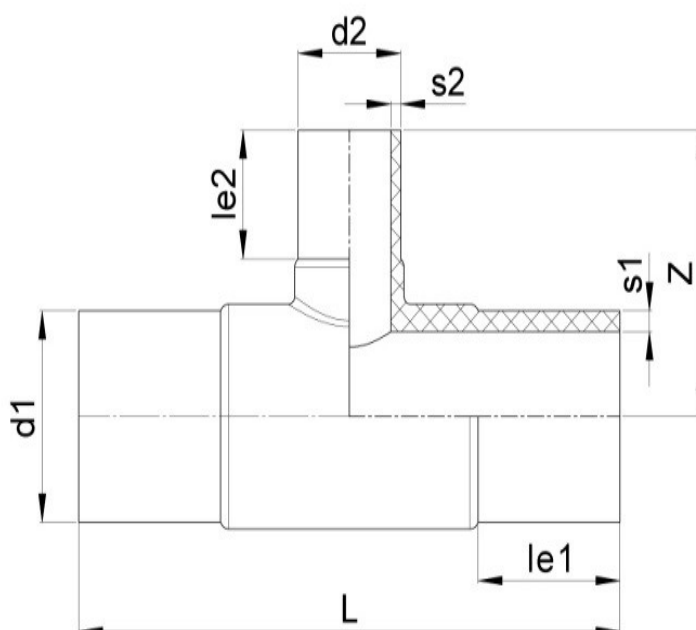

### IDENTIFICATION OF PRODUCT

D(mm)	225-90
SDR	17
RAW METARIAL	PE 100
PRESSURE CLASS	10 Bar Water 6 Bar Gas
TRADEMARK	NTG
EXECUTION	Injection Moulded
STANDARD	EN 12201-3 EN 1555-3 AS /NZS 4129

### SPECIFICATION

Long Spigot

Tolerance on diameters and thickness according to the standards. The other dimensions are specialized. Tolerance  $\pm 5\%$ . NTG PLASTIK reserves all the right to change any information without giving prior notice. The production, distribution and utilization of this document without explicit authorization is prohibited.